

Model No.DC10WA CHARGER

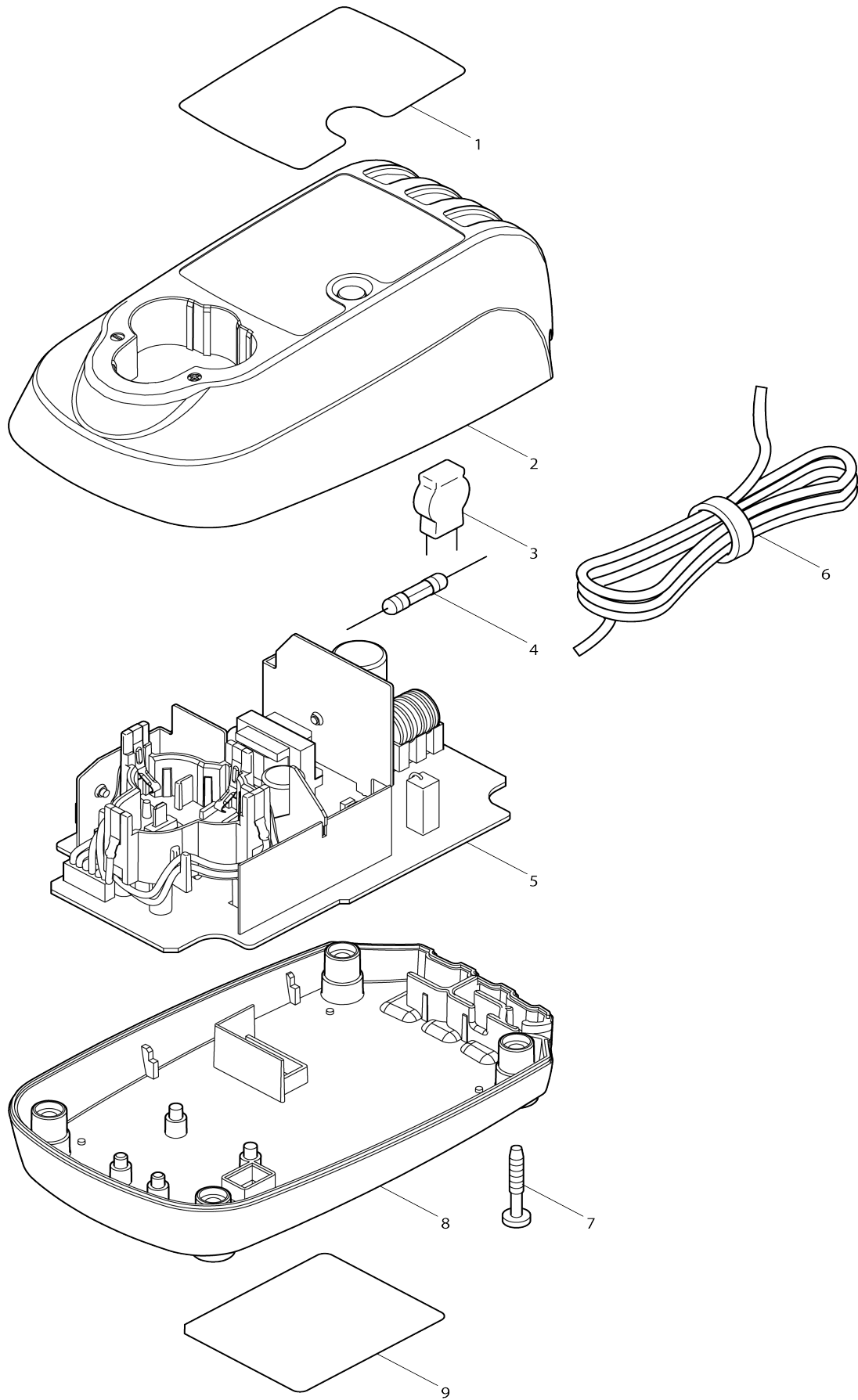

Model No.DC10WA CHARGER

Item No.	Parts No.	Description	Interchangability	Q'ty	New/Old	Note1	Note2
001	806973-3	CHARGING CONDITION LABEL		1	*		
001-1	806973-3	CHARGING CONDITION LABEL	<	1			
002	158599-0	CHARGER CASE COMPLETE		1			
003	647306-1	VARISTOR		1	*		
003-1	647117-4	VARISTOR	<	1			
004	652779-5	FUSE		1	*		
004-1	652804-2	FUSE	X	1			
005	631806-1	CHARGING CIRCUIT COMPLETE		1	*		
D10		INC. 3,4					
005-1	620M61-8	CHARGING CIRCUIT COMPLETE	<	1			
D10		INC. 3,4					
006	667985-9	VINYL CORD 0.75-2-2.0		1			
007	266355-5	TAPPING SCREW BT 4X25		4	*		
007-1	265B08-5	TAPPING SCREW PT 4X25	<	4			
008	450470-7	CHARGER CASE COVER		1			
009	864956-9	DC10WA NAME PLATE		1			
F04	194588-1	DC10WA BATTERY CHARGER SET		1			
F12	194597-0	DC10WA BATTERY CHARGER SET		1			
F17	194709-5	DC10WA BATTERY CHARGER SET		1			
F19	194711-8	DC10WA BATTERY CHARGER SET		1			
001	808024-8	CHARGING CONDITION LABEL		1	*		
002	158814-2	CHARGER CASE COMPLETE		1			
005	631836-2	CHARGING CIRCUIT COMPLETE		1	*		
005-1	620M62-6	CHARGING CIRCUIT COMPLETE	<	1			

Please state Parts No. when your order.

Print Date 17/06/2024